



\* All images in this datasheet are for illustrative purposes only.

## Indoor LED LBCK

# Ceiling LED Display for Virtual Production



Easy Installation and Maintenance



Front or Rear Serviceability



Brompton LED Processor & Data Distribution



High Brightness

### LBCK

Pixel Pitch	3.91 mm
Brightness	5,000 nit
Weight per Cabinet	12.5 kg/Cabinet
Service Access	Front or Rear (Select One Only)



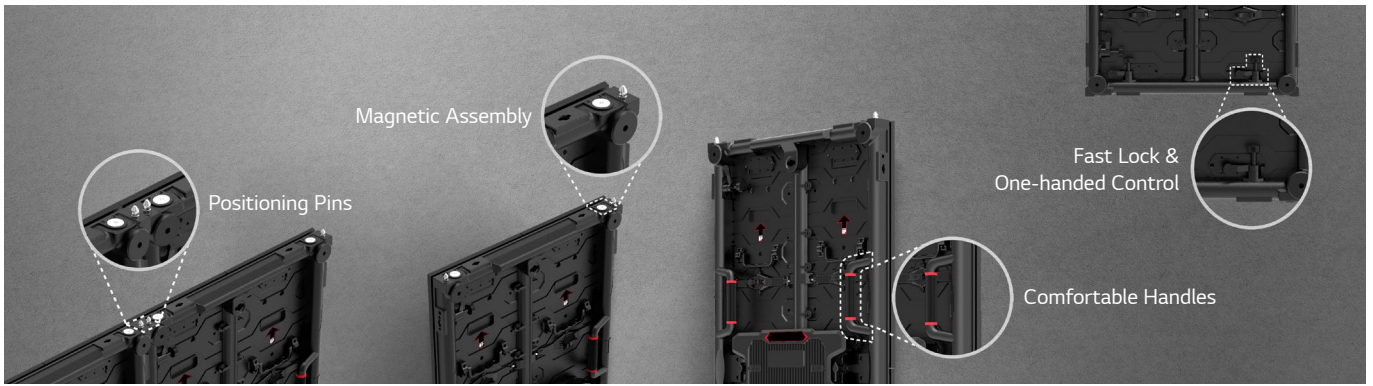

### Easy Installation & Maintenance

The module can be easily removed using the dedicated tool (with front or rear selective service access). The positioning pins and magnets help perform panel adjustments accurately and quickly, ensuring seamless screen assembly.

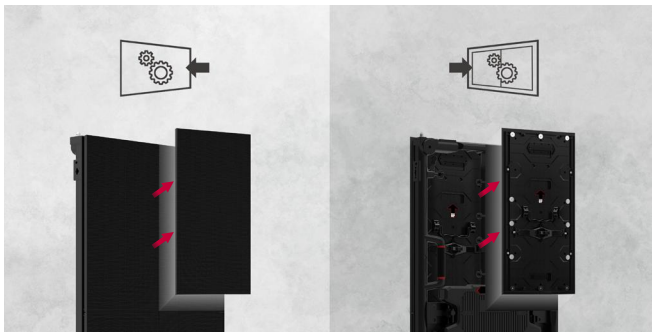

### Front or Rear Serviceability

The product offers either front access or rear access, allowing customers to choose installation options according to their need.

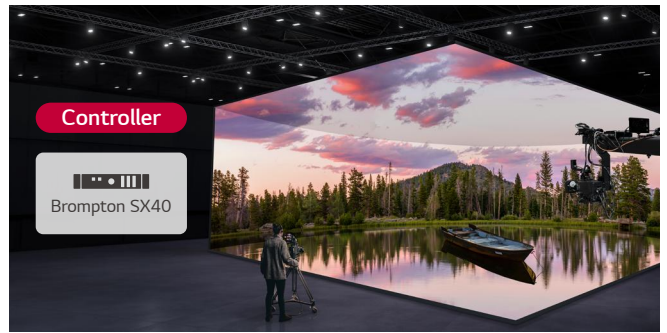

### Brompton LED Processor & Data Distribution

As Brompton controllers are common in the broadcast and virtual production industry, LBCK series offers support for them.

Approx. 400 SQM



Approx. 50 ~ 100 SQM

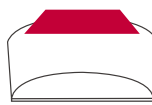

Approx. 20 ~ 50 SQM

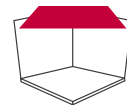

### High Brightness

The ceiling LED with 5,000 nits enables LBCK series to be used for alternative lightings in XR and virtual production.

## SPECIFICATIONS

## LBCK039-GN

Pitch Name		P3.91
Physical Parameters	Pixel Configuration	3 in 1
	Pixel Pitch (mm)	3.91
	Module Resolution (W x H)	64 x 128
	Module Dimensions (W x H, mm)	250 x 500
	Weight per Module (kg)	1.40
	No. of Modules per Cabinet (W x H)	2 x 2
	Cabinet Resolution (W x H)	128 x 256
	Cabinet Dimensions (W x H x D, mm)	500 x 1,000 x 66.05
	Cabinet Surface Area (m <sup>2</sup> )	0.500
	Weight per Cabinet (kg/Cabinet)	12.5
	Weight per Square Meter (kg/m <sup>2</sup> )	24.9
	Physical Pixel Density (pixels/m <sup>2</sup> )	65,536
	Flatness of Cabinet (mm)	±0.3
	Cabinet Material	Die Casting Magnesium
Service Access	Front or Rear (Select One Only)	
Optical Specifications	Max. Brightness (After Calibration, nit)	5,000
	Color Temperature (K)	2,000-11,000
	Visual Viewing Angle (H x V)	160 x 155
	Brightness Uniformity	97%
	Color Uniformity	±0.003 Cx, Cy
	Contrast Ratio	6,000 : 1
	Processing Depth (bit)	14 (PQ, HLG)
Electrical Specifications	Power Consumption (W/Cabinet, Max.)	300
	Power Consumption (W/Cabinet, Avg.)	100
	Power Consumption (W/m <sup>2</sup> , Max.)	600
	Heat Dissipation (BTU/h/Cabinet, Max.)	1,024
	Heat Dissipation (BTU/h/Cabinet, Avg.)	341
	Heat Dissipation (BTU/h/m <sup>2</sup> , Max.)	2,047
	Power Supply (V)	100 to 240
	Frame Rate (Hz)	50 / 60
Operation Specifications	Refresh Rate (Hz)	3,840
	LED Lifetime (Half Brightness)	100,000
	Operating Temperature (°C)	-30 to +45
	Operating Humidity	10-99% RH
	Certification	CE / FCC / ETL
	Environment	RoHS
	Controller	Brompton SX40
	90 Degree Corner Cut	No

\* Specifications are subject to change without notice. Please make sure to check the product manual for details about product usage.



Download  
LG C-Display+  
Mobile App

Google Play Store

[www.lg.com/global/business/information-display](http://www.lg.com/global/business/information-display)  
[www.youtube.com/c/LGCommercialDisplay](https://www.youtube.com/c/LGCommercialDisplay)  
[www.facebook.com/LGInformationDisplay](https://www.facebook.com/LGInformationDisplay)  
[www.linkedin.com/company/LGinformationdisplay](https://www.linkedin.com/company/LGinformationdisplay)  
[twitter.com/LG\\_ID\\_HQ](https://twitter.com/LG_ID_HQ)

LG may make changes to specifications and product descriptions without notice. Copyright © 2022 LG Electronics Inc. All rights reserved. "LG Life's Good" is a registered trademark of LG Corp. The names of products and brands mentioned here may be the trademarks of their respective owners.